

## DA 20-T BLDC

<b>Supply Voltage</b>	
Operating voltage range	10 - 16 Volt
Nominal operating voltage	14 Volt
Signal voltage	CMOS level
Current consumption	at 14 Volt
Stand by *	< 60 mA
Stall current *	730 mA
<b>Input pulse</b>	
Frame rate	2.6-2000 ms
Valid pulse lengths	1.0 – 2.0 ms
Left / Center / Right	1.0 ms / 1.5 ms / 2.0 ms
<b>Operating data at 14 Volts</b>	
Peak stall torque *	> 40 Ncm
Continuous torque *	15 Ncm
No load speed *	420° / sec.
Max. travel angle (standard)	+/- 45° = 90° total travel
Deadband (mechanical)	< 0.5°
Deadband (electrical)	< 0.25°
Position error under temperature:	< 0.3° -20° C. to +50° C. (= Delta 70° C.)
Operating temperature	-30° C. - +70° C
Max. storage temperature	-35° C. - +80° C
<b>Material / Shielding / Protection</b>	
Case	Saltwater corrosion resistant aluminium alloy / Hart-coated
Splash water resistance	Standard
Salt water resistance	Standard
EMI / RFI shielding	Standard
Motor	Brushless 12V DC Motor
Gear set	Hardened steel
Position Sensor	Wearfree, contactless sensor .
Position feedback	Standard
<b>Dimensions / Weight</b>	
Case dimensions	33.4 x 29.0 x 39.0 mm
Item Number #	# 20-T BLDC

The actuator is fully programmable using programming tool # 986

\* tolerance  $\pm 10\%$

# DA 20-T BLDC" @ 14V

speed-graph 14V      current-graph 14V

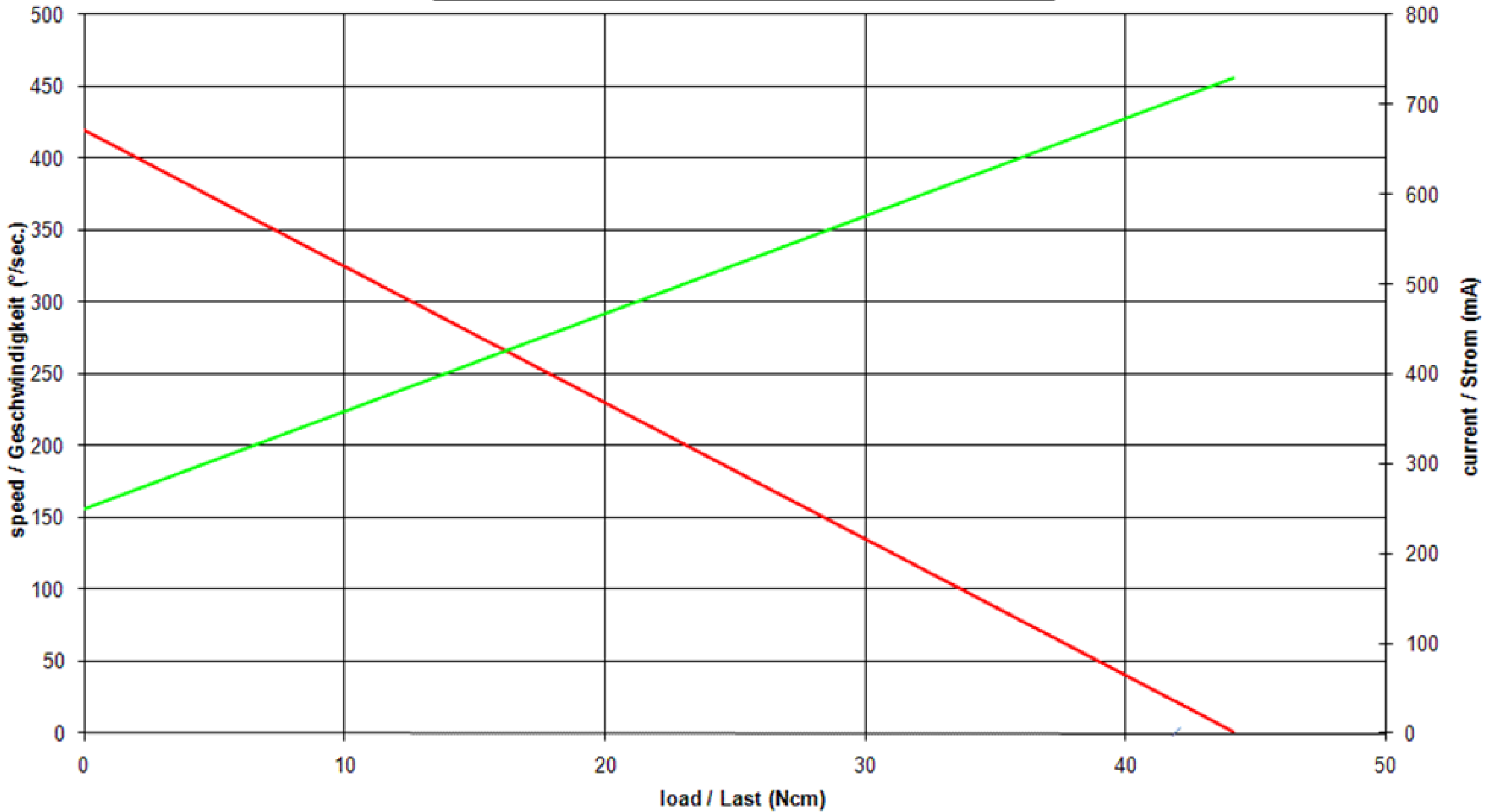

## DA 20-T Installation Dimensions

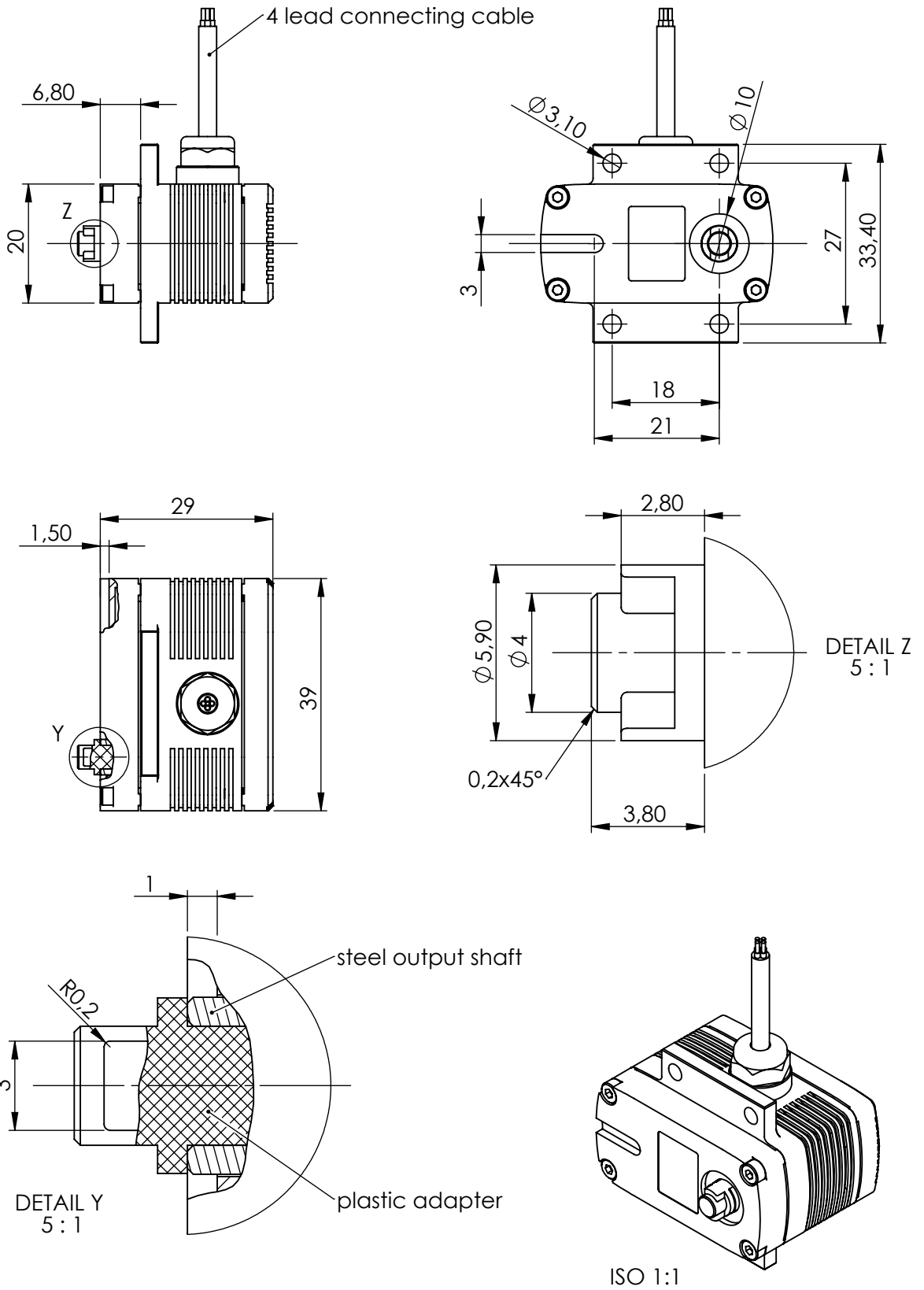

all dimensions in Millimeter